

Tip Replacement & Use For Hand-Held Cautery

This guide contains step-by-step instructions for changing tips and sheaths for hand-held cautery base units to creating a usable sterile combined cautery unit without being gloved. Sheathing and mounting process will only require 20 to 30 seconds

On a clean, non-sterile surface, remove the plastic safety cover from the power handle.



Carefully open a cautery tip peel pouch.

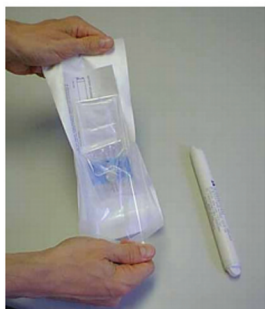
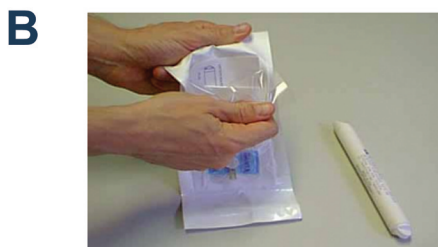

Remove the sterile double sheath from the peel pouch.

C



Insert the nose cone end of the power handle into the sheath between the white plastic and white paper tabs. Gently slide the power handle forward until the nose is at the tip of the sterile sheath.

D

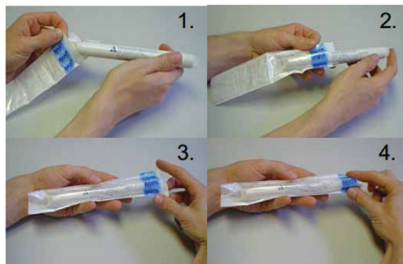

Advance the nose of the handle about 1 cm beyond the white paper backing and blue plastic stripe section, which together make up the outer sheath.

E



Touching ONLY the clear plastic tip protector, remove the sterile tip from the peel pouch.

Place the gold copper ends of the sterile tip through the inner sheath into the power handle. DO NOT FORCE. Tip should slide easily into place.

F

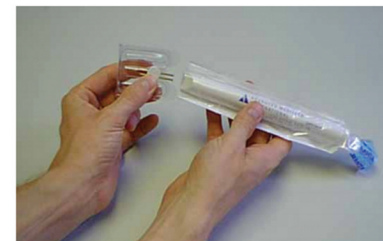

Gently pull away the clear plastic tip protector and discard. The tip remains in place.

G



Holding the unit between your palms, use your thumbs and forefingers to separate the white plastic strip from the white paper backing.

H



"Peel the Banana."

I

Holding the base unit in one hand, gently peel away the outer sheath. Be careful not to touch the sterile inner sheath with your hands.



**Vasectomy
Store.com**

Owned & Operated by AMI
P.O. Box 630414
Little Neck, NY 11363 USA

Tel: (718) 352-2981 Fax: (718) 352-2984
Toll Free (800) 635-2452